

RVB

DESIGN FEATURES

The R-K RVB series vacuum breaker features a floating disc that lifts and seals to allow full flow of liquids, DI water, chemicals, etc., and breaks the seal to permit atmospheric pressure to enter when the flow stops to prevent unwanted back siphonage and contamination from getting back into the piping system. The inlet and outlet ports are parallel and 2 cut-out slots on the base permit easy mounting. Suitable for most chemicals, wet processing stations, plating equipment, chemical processing and water treatment applications.

Note: RVB valves must be mounted horizontally.

VACUUM BREAKER

SPECIFICATIONS

Pressure Range	0 to 150 PSIG
Temperature Range	0 F to 140 F for PVC 0 F to 180 F for POLYPRO 0 F to 280 F for PVDF 0 F to 340 F for TEFLON
Material	Valve Body PVC Type 1, Grade 1 Polypropylene PVDF
	Seal EPDM VITON KALREZ
Valve ports	1/2" to 1" Valve FNPT 1.5" to 2" Valve MPT All valves are fully ported
Mounting method	(2) cut-out slots on molded valve body (1/2" to 1")

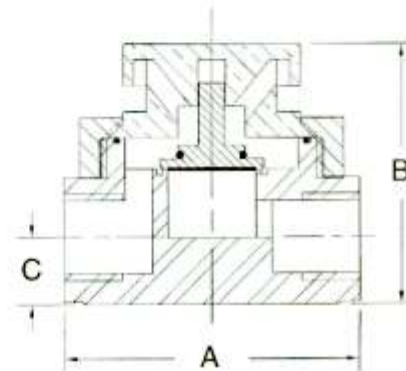

DIMENSIONAL DATA

DIMENSIONS IN INCHES () MOLDED

Size	A	B	C
1/2	(2.90)	(2.50)	(.70)
3/4	(3.30)	(3.05)	(.80)
1.0	(3.90)	(3.82)	(.90)
1.5	5.00	5.47	1.5
2.0	6.00	6.16	1.7

ORDER INFORMATION

The chart below will specify R - K standard valves regarding valve size, valve material, and seal material. For special orders, please consult the factory for pricing and delivery information.

RVB - X X X - X X		
VALVE SIZE 50 = 1/2" 75 = 3/4" 100 = 1.0" 150 = 1.5" 200 = 2.0"	MATERIAL 1 = PVC 2 = POLYPRO 3 = PVDF 5 = OTHER (Please specify)	SEALS E = EPDM V = VITON K = KALREZ O = OTHER (Please specify)
		X = MOLDED BODY (1/2"-3/4"-1" ONLY)

R-K INDUSTRIES



1120 E. LOCUST STREET
 ONTARIO, CA 91761
 (909) 947-5227 • FAX: (909) 947-3039 • <http://www.rkvalve.com>